

For DWG/CAD file of this drawing please contact Sydney Water Tanks

Please be aware of all dimensions before excavating

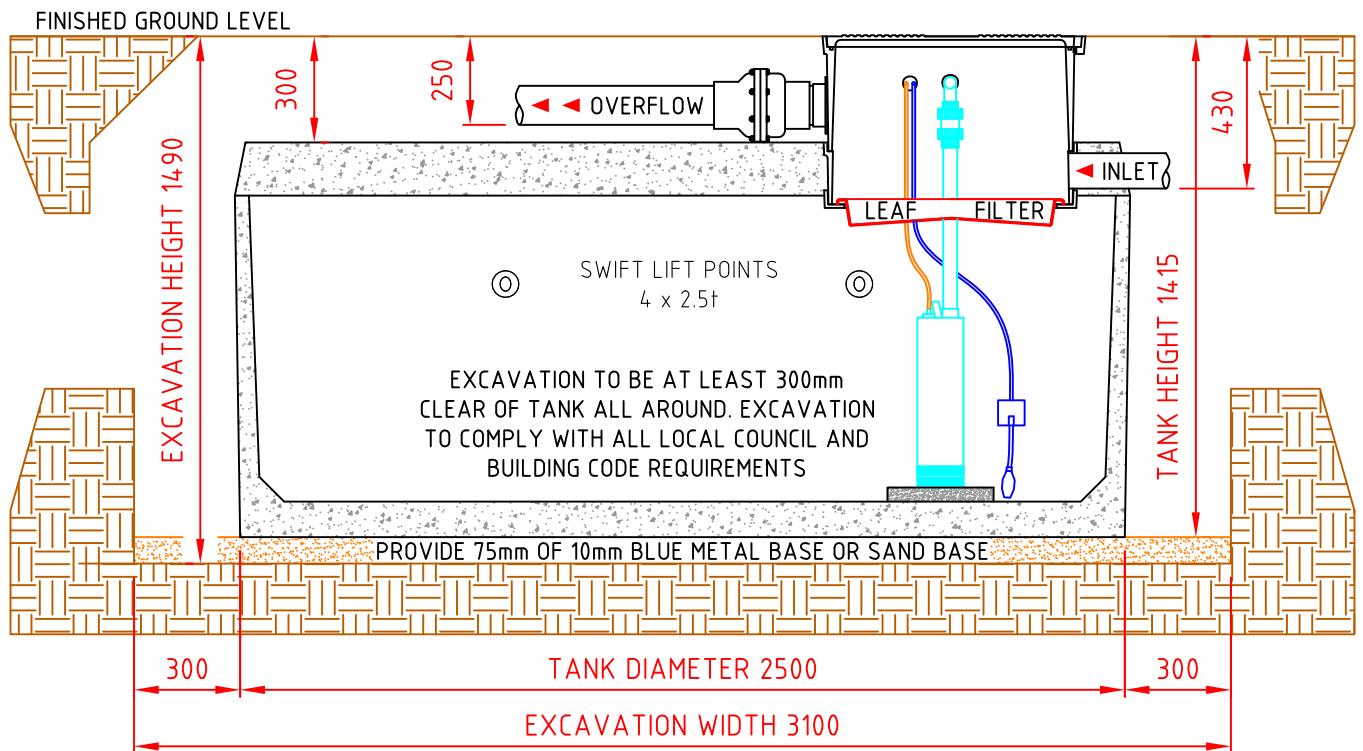

DIAGRAMMATIC SECTION DETAIL

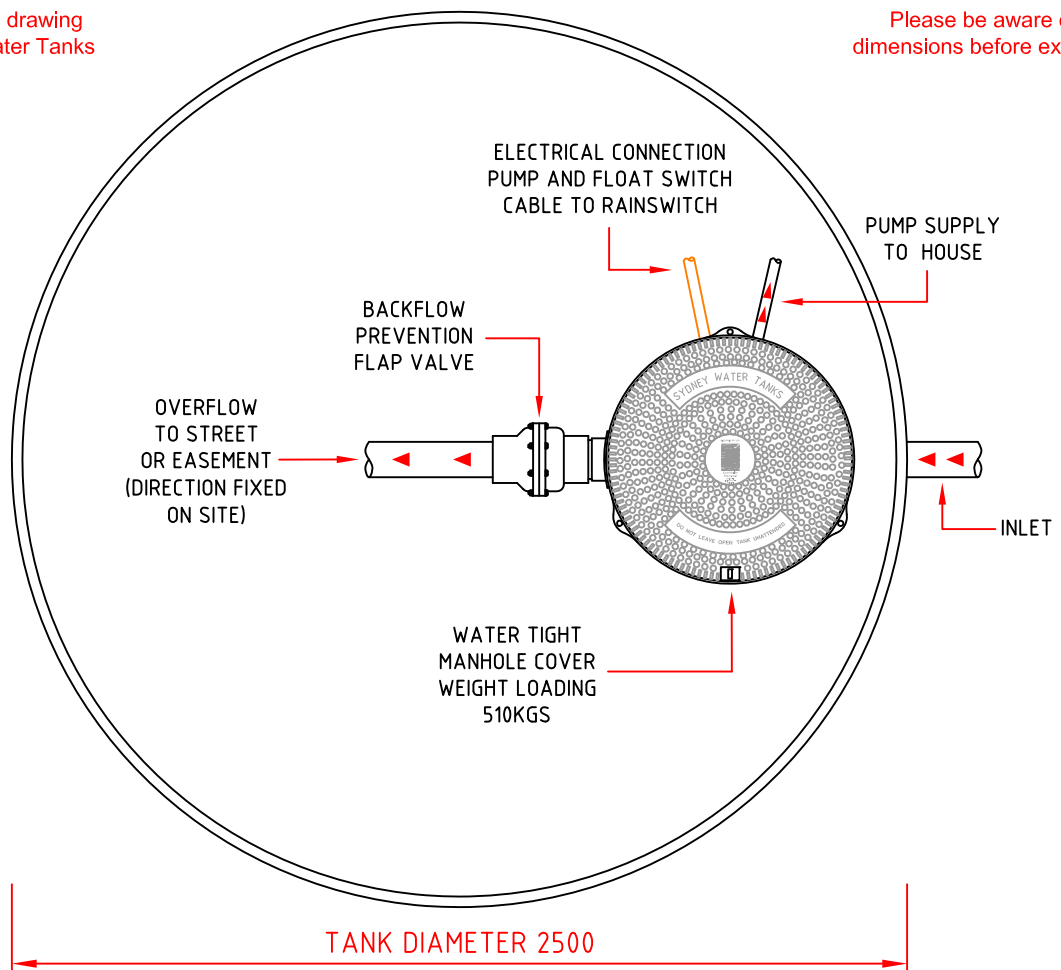

1-5 Anzac Avenue, Smeaton Grange Road  
Smeaton Grange NSW 2567  
Phone: (02) 4629 6688 Fax: (02) 4629 6677  
Email: sales@sydneywatertanks.com.au  
Web Site: www.sydneywatertanks.com.au

THE TANK IS MANUFACTURED BY BIOSEPTIC PTY LTD AND IT IS ACCREDITED TO AS/NZS 1546.1-2008

Concrete fc:	40Mpa @ 28 days
PVC fittings:	@100mm
Mass:	3.95 tonnes
Lid:	F82 mesh
Base and Walls:	Fibre steel

A4 Size Sheet  
© SYDNEY WATER TANKS,2014

Scale: 1 : 25  
Scale: 1 of 1

ISSUE G  
JUN 14

3,800Ltr Concrete Water Tank  
Model: 3,800/300